



OVERALL CONSTRUCTION

Systec's ULD features all-welded steel frame construction. The ULD is a self-contained lift table with on-board hydraulic pump package. Safety accordion skirting provided as shown.



ADJUSTABILITY

Systec's ULD has a stationary and an adjustable backstop to minimize operator efforts in load building. Both backstops are retractable in load building operations.



DRIVE ASSEMBLY

Systec's ULD lift conveyor is a self-contained drive assembly. Most components of the powered conveyor are the same as the floor conveyors.

UNIT LOAD DOWNSTACKER



DESCRIPTION

Systec's Unit Load Downstacker (ULD) is an ergonomic solution for manual load forming stations.

The features of Systec's ULD are the conveyor lift table and adjustable backstop system. The conveyor table can be elevated to a comfortable work height allowing the operator to transfer bundles of boxes from the bundle conveyor to the ULD station without bending. As each tier is completed, the operator can activate the lift, lowering it to a comfortable work height, to add the next tier of bundles to the unit load. As the lift is actuated for movement, the stationary and adjustable backstops retract for load clearance. Once the lift has been stopped, the backstops return to the original position for continuation of load building. The ULD adjustable backstop can be adjusted to position the unit load as required, and minimize the effort.

As with all Systec conveyor and devices, the ULD is all welded steel construction, using precision laser cut parts for exact fit and function. This is a very low maintenance device applying the most advanced safety designs and features.

UNIT LOAD DOWNSTACKER (ULD)

UNIT LOAD DOWNSTACKER (ULD)

SPECIFICATIONS

Between Frame Dimension	60", 72", 84"
Device Lengths	5'-0", 6'-0", 7'-0"
Top-of-Roller Height	12" T.O.R. to 36" T.O.R.
Drive Capacity	3,500lb/unit
Conveyor Speeds	30, 40, and 60 FPM
Motor/Drive Package	Flange Mounted Gearbox, 1 3/8" Through Shaft, 1HP, 230/460 Volt, 3 Phase, 60 Hertz
Air Requirement	40PSI

CONSTRUCTION

Frame	All-Welded Steel Construction
Lift Assembly	All-Welded Steel Construction, Laser Cut and Precision Machined Components
Backstop Assemblies	Steel Frame Construction With 3/4" Plywood Backing Scissor Action, 1M1A Air mount In/Out Actuation

CONTROL OPTIONS

Automatic	Positioning Controls with Electro-mechanical Sensor Actuation
Manual	Pushbutton Operation

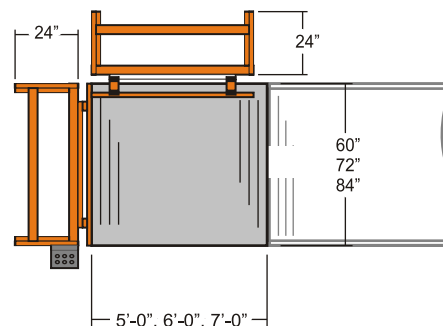
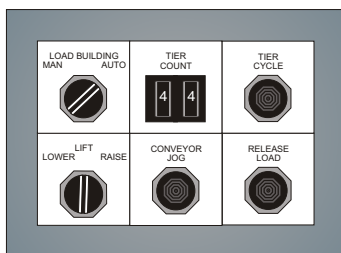

The Leader in Conveyor Innovation!

10010 Conveyor Drive - Indianapolis, IN 46235
Tel: 317-890-9230 / 800-578-1755 Fax: 317-890-9232
www.systecconveyors.com

