



OVERALL CONSTRUCTION

Systemec's PTD features all-welded steel frame construction. Heavy gauge steels and precision cut laser parts ensure tighter tolerances resulting in longer life of components and the overall device.



HEAD TROLLEYS

Systemec's PTD features an adjustable head for added clearance when needed for extra wide loads. Internal adjustments, such as chain tensioning are easily accomplished at the trolley head hook-up points.

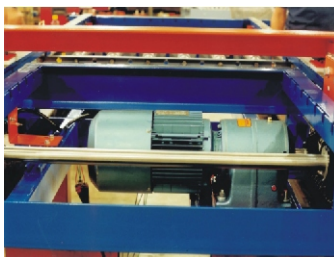

DRIVE ASSEMBLY

Systemec's PTD drive assembly is equipped with a common shaft, and dual drive chains. This assures even movement and pressure on the load being transferred.

PUSHER TRANSFER DEVICE



DESCRIPTION

Systemec's Pusher Transfer Device (PTD) is an integral section of a conveyor line. The device can be equipped with a conveyor drive section, takeup section, midsection, or can be a gravity conveyor. The PTD can be set in the line so that it will push either to the right, or left. For special applications, the device can be modified to push loads in both right and left directions. Typically the load would be pushed to a perpendicular or parallel conveyor line. The PTD can be used with a Sheet Gripping Device (SGD) for transferring loads that need to be placed on a deck, or bottom dunnage sheets.

Systemec's PTD is a very reliable and durable transfer mechanism. The heavy duty trolley assemblies are equipped with large diameter rollers for smooth movement and load transfer. Additionally, they are assembled with cam rollers for precise trolley tracking and movement.

The PTD can be used in Powered Accumulating Roller conveyor (PAR), Powered Roller Only conveyor (PRO), or in Gravity Roller Conveyor (GRC) applications. The PTD is sized based upon the conveyor line in which it is used. The device's head is also sized based upon the maximum size load it will be transferring.

The PTD is an all-welded, steel frame construction, using precision laser cut parts for exact fit and function. This is a very low maintenance device applying the most advanced safety designs and features.

PUSHER TRANSFER DEVICE (PTD)

PUSHER TRANSFER DEVICE (PTD)

SPECIFICATIONS

Between Frame Dimension	48", 60", 72", 84", 96"
Lengths (head length)	4'-0" - 8'-0" on 1'-0" increments
Top-of-Roller Height	12" T.O.R. Standard (heights over 12" available)
Drive Capacity	3,500lb/unit
Conveyor Speeds	Determined by conveyor drive section, or internal drive package
Head Speed	45 or 60 FPM
Head Drive	1.5 HP Foot Mounted
Air Requirement	55 PSI (for accumulating conveyor section)

CONSTRUCTION

Frame	All-welded steel construction
Head and Drive Mechanism	Heavy gauge steel head and trolley assemblies
Chain Drive	Dual #60 Chain

SAFETY FEATURES

Frame	Guarding on all moving parts
-------	------------------------------

CONTROL OPTIONS

Automatic	Positioning Controls with Electro-mechanical Sensor Actuation
Manual	Pushbutton Operation

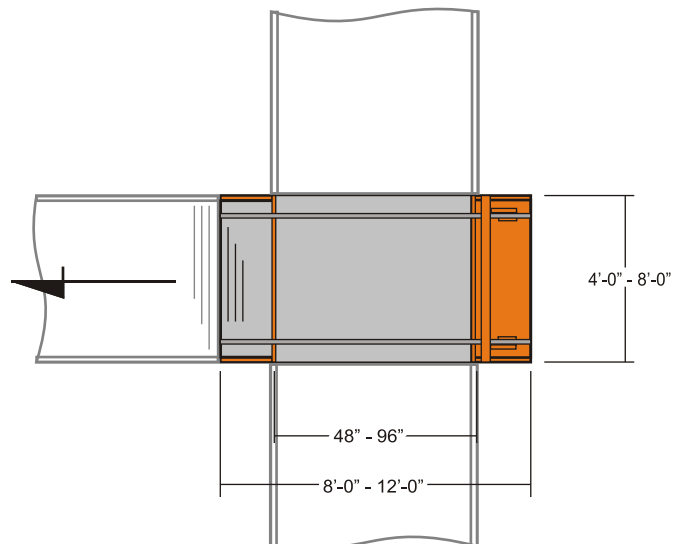
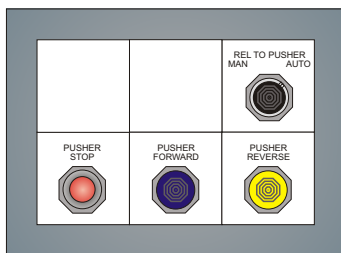

The Leader in Conveyor Innovation!

10010 Conveyor Drive - Indianapolis, IN 46235
 Tel: 317-890-9230 / 800-578-1755 Fax: 317-890-9232
 www.systecconveyors.com

