

POP-UP INFEED DEVICE

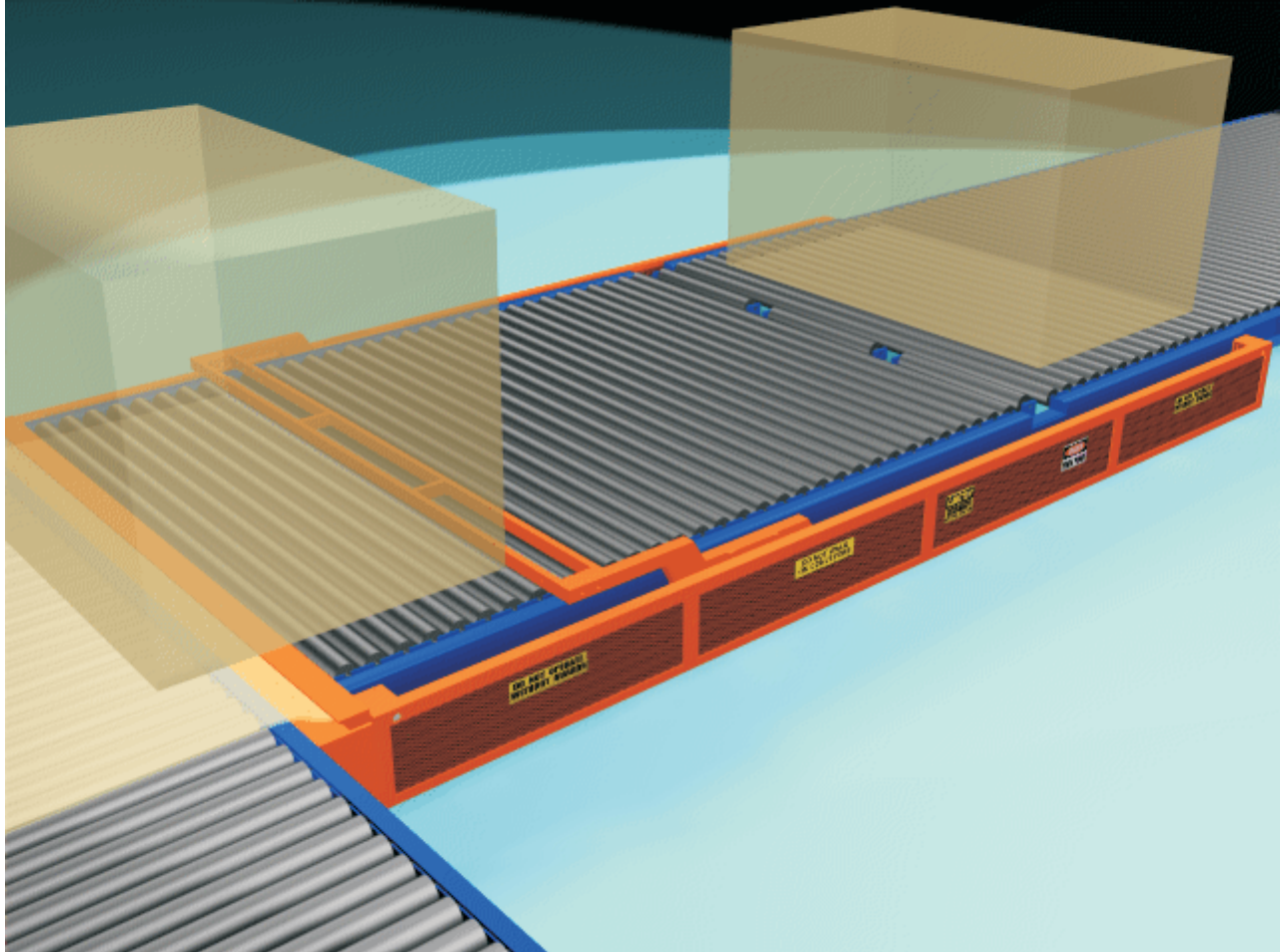

SERVICE AND MAINTENANCE MANUAL

TABLE OF CONTENTS

DESCRIPTION	PAGE NO.
Pop-up Infeed Device	2
Conveyor Safety	3
PID Service and Parts	5
Parts Information	7
Maintenance Schedule	9

LIST OF ILLUSTRATIONS	PAGE NO.
A Pop-up Infeed Device	2
B Safety Label Locations	3
C Lockout Switch for Safety	4

LIST OF ASSEMBLY DRAWINGS	PAGE NO.
1 PID Load Carrying Rollers	5
2 Drive Assembly	6
3 Idler Assembly	6
4 Pop-up Head Slider Arm Assembly	6
5 Pop-up Slider Arm Tow Plate Assembly	6

When ordering parts, please call, fax or e-mail Systec at the address and/or the numbers shown below.

SYSTEC Conveyors Parts Department
10010 Conveyor Drive
Indianapolis, IN 46235

Tel 317.890.9230
1.800.578.1755
Fax 317.890.9232

On The Net @ <http://www.systecconveyors.com/>
e-mail: info@systecconveyors.com

POP-UP INFEED DEVICE

The information within this manual covers SYSTEC's standard Pop-up Infeed Device. Throughout this manual the device will be referred to as a PID.

The PID is designed to be used inside a conveyor line to transfer a load on to a perpendicular conveyor line, a mobile cart, or when used in conjunction with a Sheet Gripping Device transfer the load on to a deck sheet.

This device has been designed to allow the head to move from its home position without leaving a void in the conveyor bed. When compared to other similar devices, where an operator or maintenance personnel can step in to a void in the conveyor and become trapped, the safety aspect of this design becomes evident.

The device can be electrically controlled to operate either manually or automatically, depending on control options purchased.

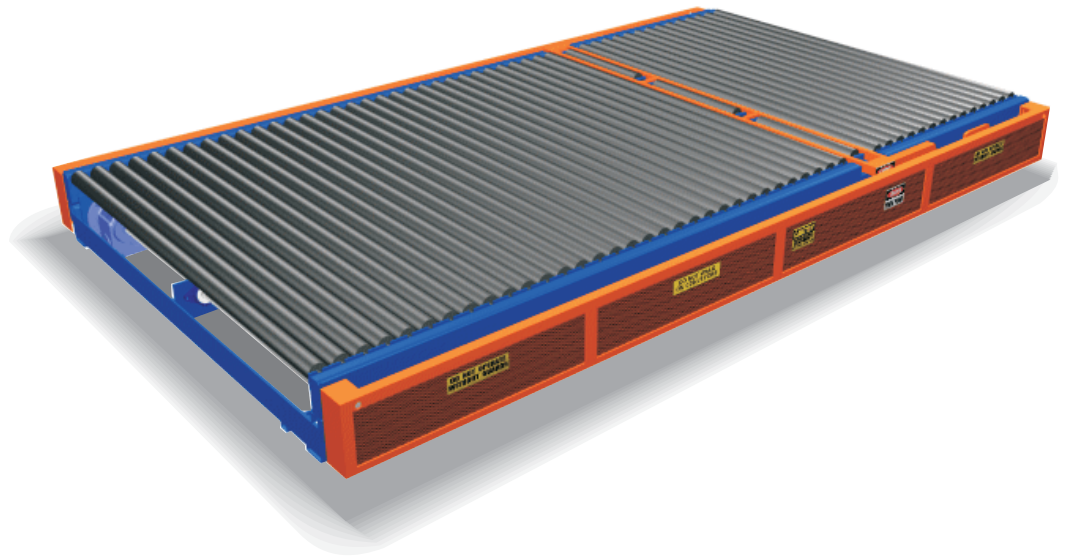

POP-UP INFEED DEVICE

ILLUSTRATION A

CONVEYOR SAFETY

Where safety is concerned, conveyor and its devices are no different from any machinery or processing equipment. In many cases, the conveyor and devices can start running without notice.

SYSTEC designs all its equipment to be as safe as possible by installing guarding, or providing safety labels on all conveyor and devices. These labels are in place to warn personnel working on or around the conveyor system of the inherent dangers that exist with any conveyor or machinery.

SYSTEC Conveyors also believes that a conveyor safety session should be incorporated into your existing safety training program to educate all personnel that work on or around conveyor systems of these potential safety concerns.

Below is Illustration B, showing the safety labels provided with **SYSTEC's** PID. These labels should be installed to alert personnel of the potential hazards caused by improper use of the conveyor equipment. Where foot traffic exists, personnel should be discouraged from walking on a conveyor line.

Should you need additional labels, please contact **SYSTEC's** Parts Department at the address or phone numbers shown in the front of this manual.



ILLUSTRATION B

Notes:

Exact location of Motor Switch labels are determined by the mounting location at the time of installation.

CONVEYOR SAFETY (continued)

Lockout is a very important part of your Maintenance and Service Department procedures. SYSTEC provides a Lockout Switch, as shown in illustration C, for each drive motor.

LOCKOUT SWITCH FOR SAFETY



ILLUSTRATION C

Note: Only authorized personnel should perform service and maintenance on any conveyor equipment and controls.

PID SERVICE AND PARTS

The drawings within this section are designed to help you understand how components of the PID are assembled and disassembled. The exploded views also allow you to quickly and easily identify the parts that may need to be serviced and/or repaired.

The parts identification page(s) provide the corresponding part numbers to the drawings and indicates recommended quantities you should stock for each PID, along with the parts descriptions, part numbers, and order quantities. This is a faxable form, for your convenience, to order parts for stock or needed replacement parts. Simply fill in the order quantity, the necessary purchase order number and shipping information, then fax the form to **SYSTEC** Conveyor's at the number shown on the form. An Order Acknowledgement will be faxed back with the estimated ship date and pricing information.

The drawing below shows the PID and the load carrying rollers, which may not match the infeeding and outfeeding conveyor sections. Be sure, when ordering, to specify the exact size of rollers needed and identify for **SYSTEC**'s Parts Department the device type for which the rollers are needed.

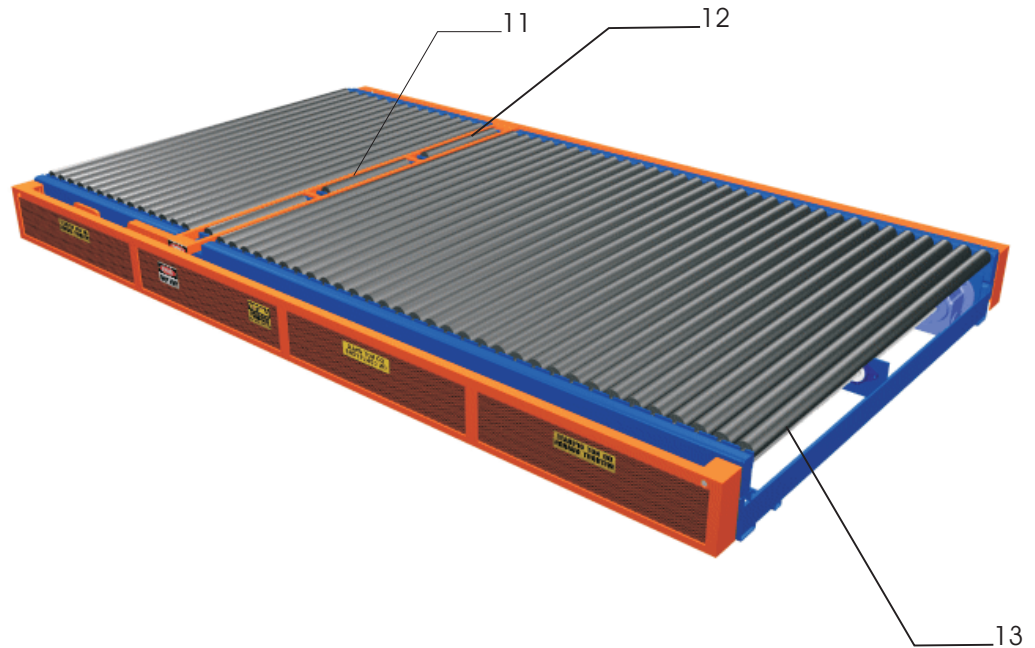

PID LOAD CARRYING ROLLERS

ASSEMBLY DRAWING 1

Notes:

Lockout switch location is determined at time of installation.

PID SERVICE AND PARTS (continued)

ASSEMBLY DRAWING 2

Notes:
Provide all gearmotor Data Plate information when ordering replacement/stock gearmotors

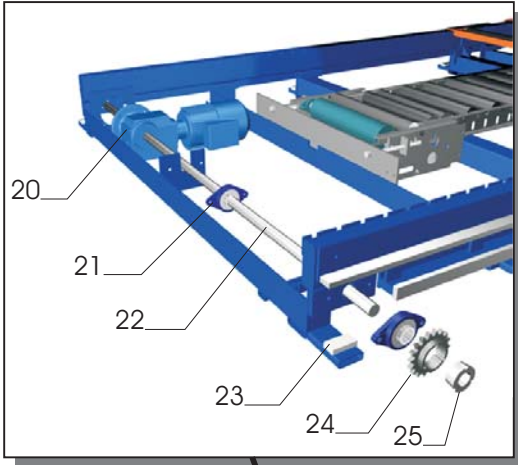

ASSEMBLY DRAWING 3

Notes:
Idler sprockets are identical on both sides of the assembly.

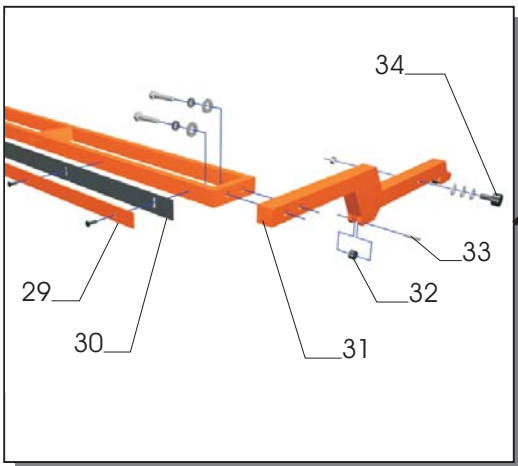
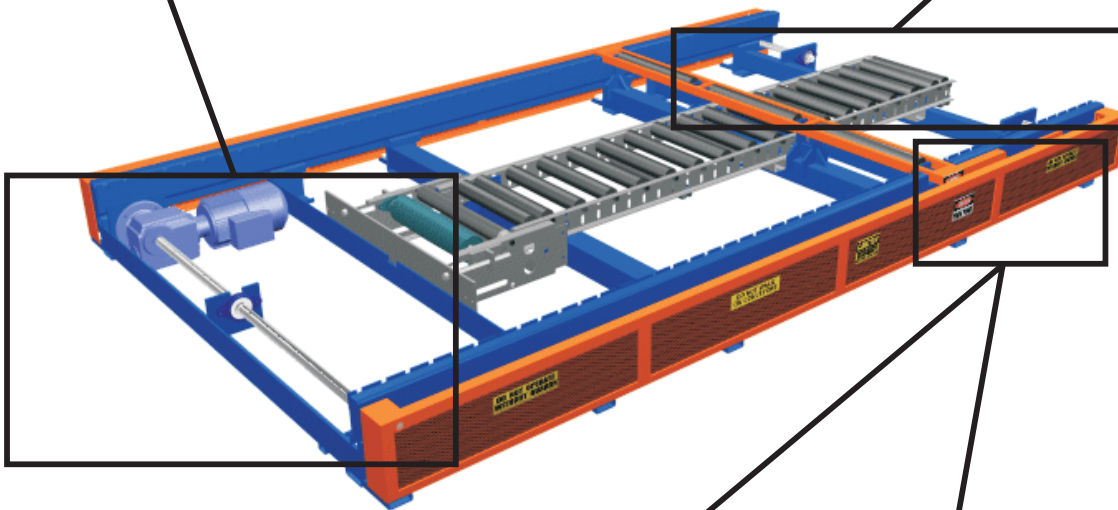
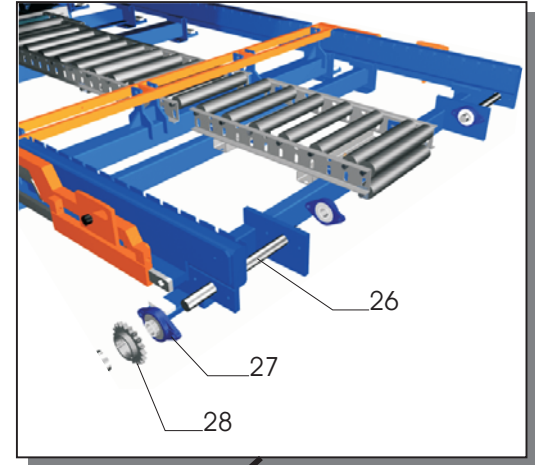

ASSEMBLY DRAWING 2

Notes:
The wiper strip belt should be adjusted to just skim the roller surface.

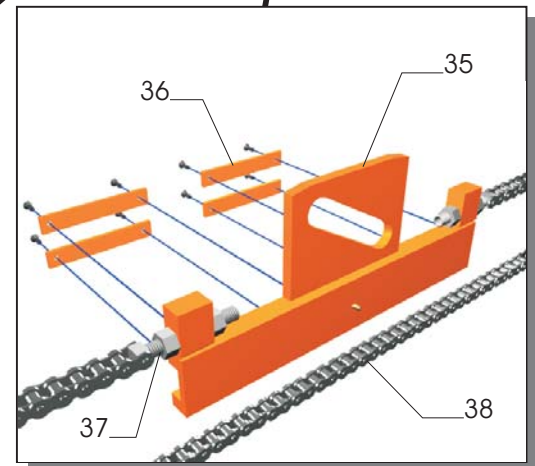

ASSEMBLY DRAWING 3

Notes:
The head tow plate has adjustments on both ends for chain tensioning and alignment.

Some items on this parts list require "fill-in" or additional information to receive the needed part. Please be sure to provide all information requested on this list, or within this manual to assure that you do in fact get exact replacement parts. SYSTEC's Parts Department will assist you in obtaining the proper part information, or answering any questions by calling 1-800-578-1755.

Item	Qty.	Rec. Spare	Description	Part Number	Gr.	Order Qty.
1	2		Safety Label - Pinch Point	000-0301	-00	
2	2		Safety Label - Automatic Equipment	000-0300	-00	
3	4		Safety Label - Do Not Operate Without Guards	000-0302	-00	
4	1		Safety Label - Motorswitch Location	000-0307	-00	
5	1		Safety Label - Lock Out For Safety	000-0305	-00	
6	2		Safety Label - Do Not Walk On Conveyor	000-0303	-00	
10	1	1	Lockout Switch	000-0118	-95	
11	1		15" Roller, 2-1/2" Dia., 11/16" HEX, 11ga, S.L.	10D0150	04	
	1		21" Roller, 2-1/2" Dia., 11/16" HEX, 11ga, S.L.	10D0150	06	
12	2		12" Roller, 2-1/2" Dia., 11/16" HEX, 11ga, S.L.	10D0150	03	
	2		15" Roller, 2-1/2" Dia., 11/16" HEX, 11ga, S.L.	10D0150	04	
	2		21" Roller, 2-1/2" Dia., 11/16" HEX, 11ga, S.L.	10D0150	06	
	2		27" Roller, 2-1/2" Dia., 11/16" HEX, 11ga, S.L.	10D0150	06	
	2		33" Roller, 2-1/2" Dia., 11/16" HEX, 11ga, S.L.	10D0150	10	
13	*		48" Roller, 2-1/2" Dia., 11/16" HEX, 11ga, L.O.	10D0020	11	
	*		60" Roller, 2-1/2" Dia., 11/16" HEX, 11ga, L.O.	10D0020	13	
	*		72" Roller, 2-1/2" Dia., 11/16" HEX, 11ga, L.O.	10D0020	15	
	*		84" Roller, 2-1/2" Dia., 11/16" HEX, 11ga, L.O.	10D0020	18	
	*		96" Roller, 2-1/2" Dia., 11/16" HEX, 11ga, L.O., Galvanized	10D0019	00	
	*		__" Roller, 2-1/2" Dia., 11/16" HEX, 11ga, L.O.	**		
20	1	1	Gearmotor, Pop-Up Infeed Device	500-1500	-00	
21	3	1	Bearing, 2-Bolt Flange 1-3/8" Bore (Setscrew Locking)	580-2030	-00	
22	1		Pop-Up Infeed Driveshaft X 60-1/2" L.	19D0226	01	
	1		Pop-Up Infeed Driveshaft X 72-1/2" L.	19D0226	02	
	1		Pop-Up Infeed Driveshaft X 84-1/2" L.	19D0226	03	
	1		Pop-Up Infeed Driveshaft X 96-1/2" L.	19D0226	04	
	1		Pop-Up Infeed Driveshaft X 108-1/2" L.	19D0226	05	
23	8	2	Pop-Up Infeed Chain Wear Pad Mtg. Block (10'0" L. PID)	19A0017	00	
	10	2	Pop-Up Infeed Chain Wear Pad Mtg. Block (12'0" L. PID)	19A0017	00	
24	2	1	Sprocket, 60TI 18 Taper Lock	550-1050	-00	
25	2	1	Bushing, 1610 TL 1-3/8" I.D. W/ 5/16" Keyway	560-0101	-00	
26	2		Pop-Up Infeed Idler Shaft X 19" L.	19D0228	00	
27	2	1	Sprocket, 60TI 18 Taper Lock	550-1050	-00	
28	2	1	Bushing, 1610 TL 1-3/8" I.D. W/ 5/16" Keyway	560-0101	-00	
29	1		Pop-Up Infeed Wiper Mtg. Plate X 52-1/4" L.	19D0120	01	
	1		Pop-Up Infeed Wiper Mtg. Plate X 64-1/4" L.	19D0120	02	
	1		Pop-Up Infeed Wiper Mtg. Plate X 76-1/4" L.	19D0120	03	
	1		Pop-Up Infeed Wiper Mtg. Plate X 88-1/4" L.	19D0120	04	
	1		Pop-Up Infeed Wiper Mtg. Plate X 100-1/4" L.	19D0120	05	

Item	Qty.	Rec. Spare	Description	Part Number	Gr.	Order Qty.
30	1		Pop-Up Infeed Wiper X 52-1/4" L.	19D0121	01	
	1		Pop-Up Infeed Wiper X 64-1/4" L.	19D0121	02	
	1		Pop-Up Infeed Wiper X 76-1/4" L.	19D0121	03	
	1		Pop-Up Infeed Wiper X 88-1/4" L.	19D0121	04	
	1		Pop-Up Infeed Wiper X 100-1/4" L.	19D0121	05	
31	1		Pop-Up Infeed Head Support Arm Assembly - Right Hand	19D0105	01	
	1		Pop-Up Infeed Head Support Arm Assembly - Left Hand	19D0105	02	
32	6	2	Dowel Pin 1/4" X 1-1/2" L.	845-0345	-00	
33	6	2	Cam Follower 7/8" Dia. Non-Studded	985-9100	-00	
34	2	1	Cam Follower 1-1/4" Dia. 1/2-20	985-9000	-00	
35	1		Pop-Up Infeed Slide Weldment - Right Hand	19C0003	00	
	1		Pop-Up Infeed Slide Weldment - Left Hand	19C0004	00	
36	8		Pop-Up Infeed Slide Mechanism Retaining Plate	19B0006	00	
37	4		Screw, Square Head Set, 5/8-11 X 4" L.	785-2250	-70	
38	2	1	Chain #60 Import X 40'0" L. (10'0" L. PID)	540-0300	-00	
	2	1	Chain #60 Import X 44'0" L. (12'0" L. PID)	540-0300	-00	

* Please specify Quantity and/or Length for any bill-of-material items with an asterisks.

For gearmotor information refer to Page 8, as indicated in this material list, to identify the motor and gearbox data plate information needed to order exact replacement parts.

This Maintenance Schedule is intended to cover all basic types of conveyor and the related devices and components. Although your system may not have all the parts listed below this schedule should help in identifying those components or parts that may require service or inspection that may otherwise be neglected. Should you need assistance in identifying the location of some of these components, contact **SYSTEC's** Customer Service Department at **1-800-578-1755**.

ITEM	INSPECTION OR SERVICE REQUIRED	HOURS IN SERVICE				
		500	1,000	2,500	5,000	10,000
Gearmotor	Clean, Check for Noise, Leaks, and Mounting	X				
	Check Oil Level			X		
	Change Oil					X
Bearings	Check Roller Bearings for Noise				X	
	Check Pillow Block (PB) and Flange Block (FB) bearings for Noise, Mounting, and *Lubrication	X				
Belt	Check for Belt Ware, Tracking and Tension		X			
Chains	Check Tension, Wear, Lube and Adjustment	X				
Wire Cables	Check Tension, Wear, and Adjustment	X				
Springs	Check Tension, Wear, and Adjustment	X				
Sprockets	Check Alignment, Wear and Mounting	X				
Pulleys	Check Alignment, Wear and Mounting	X				
UHMW Blocks and Pads	Check for Wear and Fit			X		
Cams and Rollers	Check for Wear and Alignment	X				
Transfer Rails	Clean with Degreaser	X				
Photoeyes	Clean with Soft Cloth or Dry High Pressure Air	X				
Limitswitches	Clean debris and Check Arm for Free Movement	X				
Proximity Switch	Clean Debris and Check for Proper Operation	X				
Pendant Switch	Check for Proper Operation			X		
Lockout Switch	Check for Proper Operation and Safety Labels			X		
Foot Switch	Check for Proper Operation			X		
Foot Valve	Check for Proper Operation			X		
Strobe Light	Check for Proper Operation			X		
Sound Alert	Check for Proper Operation			X		
Motion Detector	Check for Proper Operation			X		
Load Measuring Device	Check for Proper Operation			X		
Air Filter/Regulator	Check and Clean Trap and Adjust Pressure	X				
Solenoid Valve	Check for Air Leaks			X		
Air Mount (air bag)	Check for Air Leaks	X				
Air Supply Line	Check for Air Leaks	X				

* Check bearing type for regreasable (zerk) fitting. Some bearings may be "sealed-for-life" and do not require regreasing.

